



InvisiLight® Facade Solution

Invisible fiber. Visible results.

FACADE: A LIGHTERA FTTX SOLUTION

Applying our Award-Winning Optical Fiber to the Exterior of Your Building

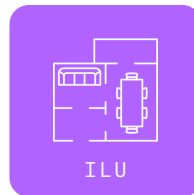

Solving an old pain point of visible exterior cabling or raceways, with a new, virtually invisible approach to placing fiber on and into buildings

SIMPLIFY YOUR FIBER DEPLOYMENT

PRODUCTS USED

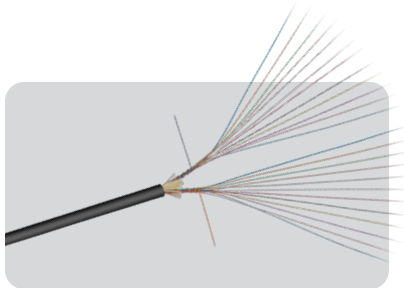

InvisiLight Facade Cord
M-Pack® Indoor/Outdoor Cord



SlimBox® 2- or 4-Fiber
Indoor/Outdoor Enclosure
Outside to the Living Unit

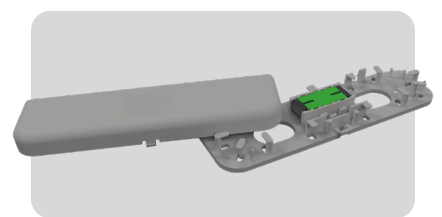

Outdoor Compact POE Module
UV Rated for
Breezeway Applications

InvisiLight® Facade Solution

VERTICAL AND HORIZONTAL APPLICATIONS



InvisiLight® Facade Cord M-Pack® Indoor/Outdoor Cord

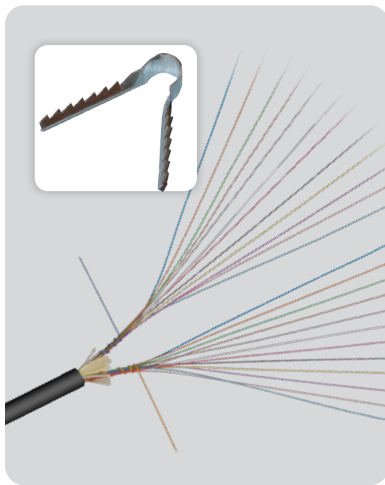

FEATURES AND BENEFITS

- Allows direct routing from building exteriors into living areas
- Compact and lightweight Multiple Dwelling Unit (MDU) Drop Cable
- Features Lightera award-winning EZ Bend® Optical Fiber, better than ITU G.657B3, 2.5 mm bend radius
- White or black outer jacket to blend into building's existing exterior
- 3.0 - 3.8 mm cable
- Easily secured with Sharktooth Anchors
- May be stapled or bent around sharp corners
- Available pre-connectorized on the network facing end with SC, LC, or MTP connectors

M-Pack Indoor/Outdoor Cord Ordering Information

PART NUMBER	PRODUCT CODE	DESCRIPTION
PR1-001-575-0273	MO30-012B-DPW-4-12-250-RIB-2000FT	EZ-Bend Indoor/Outdoor Plenum 3.0mm 12-Fiber Cord White - RIB - 2000FT
PR1-001-582-0273	MO30-012B-DPK-4-12-250-RIB-2000FT	EZ-Bend Indoor/Outdoor Plenum 3.0mm 12-Fiber Cord Black - RIB - 2000FT
PR1-001-576-0273	MO38-024B-DPW-4-12-250-RIB-2000FT	EZ-Bend Indoor/Outdoor Plenum 3.8mm 24-Fiber Cord White - RIB - 2000FT
PR1-001-583-0273	MO38-024B-DPK-4-12-250-RIB-2000FT	EZ-Bend Indoor/Outdoor Plenum 3.8mm 24-Fiber Cord Black - RIB - 2000FT

ACTUAL SIZE SHOWN

12-Fiber InvisiLight® Facade Cord (3.0 mm)

24-Fiber InvisiLight® Facade Cord (3.8 mm)

EZ-Bend® 3.0 mm Cord

Occasionally Used to Distribute from the SlimBox to 4 Living Units

InvisiLight® Facade Solution

BREEZEWAYS AND HORIZONTAL APPLICATIONS:
MULTIPLE LIVING UNITS PER FLOOR (APARTMENTS, HOTELS)



Outdoor Compact POE Module



FEATURES AND BENEFITS

- Compact dimensions
- Discreet appearance
- UV-resistant material
- Easy to secure on the wall with two screws
- Internal fiber guides for easy installation
- Can be installed on any vertical plane surface
- Plastic body offers high mechanical resistance and an efficient design
- Accommodates splice protectors (40 mm)

Indoor/Outdoor Compact POE Module Ordering Information

PART NUMBER	PRODUCT CODE	DESCRIPTION
NVSLGHTHO-CMODULE-GRY-W/ SCA ADAPTER	301145751	Compact Point-of-Entry (POE) Module, Indoor/outdoor, gray, SCA
NVSLGHTHO-CMODULE-GRY-W/ LCA ADAPTER	301152880	Compact Point-of-Entry (POE) Module, Indoor/outdoor, gray, LCA

InvisiLight® Facade Solution

VERTICAL APPLICATIONS: 1 LIVING UNIT PER FLOOR
(TOWNHOUSES, CONDOMINIUMS)



SlimBox® 2- or 4-Fiber Indoor/Outdoor Enclosure

Installed Outside of Living Unit or On Each Floor (for Multiple Units per Floor)



FEATURES AND BENEFITS

- Protection level up to IP65
- Splicing and adapter connections inside the module
- Can be wall mounted or pole mounted
- Available as a pre-terminated product with the InvisiLight® Facade Cords

PRODUCT DESCRIPTION

The SlimBox 2- and 4-Fiber Indoor/Outdoor Enclosures are an excellent choice as an external demarcation closure, featuring dual functionality as either a splice or connector housing.

It is compact and inconspicuous enough to satisfy property owners, while protecting the valuable fusion splices and/or connectors inside.

Ordering Information for SlimBox 2-Fiber Indoor/Outdoor Enclosure

PART NO.	PRODUCT CODE	MATERIAL DESCRIPTION
301139630 (no adapters)	SLIMBOX-H,OUTDOORSVI-02FIBER-INSIDEADP	SlimBox Indoor/Outdoor Wall Mount Unit for 2 Internal SC Adapters
301139648	WSE1S-002-SS21-GRY-SCAUNC-F	SlimBox I/O Wall Mount Unit with 2 Internal SCA Adapters
301139655	WSE1W-002-SS21-GRY-SCAUNC-F-PT	SlimBox I/O Wall Mount Unit with 2 Internal SCA Adapters and 2 SM Pigtailes
301139663	WSE1S-002-SS21-GRY-SCUUNC-F	SlimBox I/O Wall Mount Unit with 2 Internal SCU Adapters
301139671	WSE1W-002-SS21-GRY-SCUUNC-F-PT	SlimBox I/O Wall Mount Unit with 2 Internal SCU Adapters and 2 SM Pigtailes

Ordering Information for SlimBox 4-Fiber Indoor/Outdoor Enclosure

301139689 (no adapters)	SLIMBOX-H,OUTDOORSVI-04FIBER-INSIDEADP	SlimBox Indoor/Outdoor Wall Mount Unit for 4 Internal SCA Adapters
301139697	WSE1S-004-SS41-GRY-SCAUNC-F	SlimBox I/O Wall Mount Unit with 4 Internal SCA Adapters
301139705	WSE1W-004-SS41-GRY-SCAUNC-F-PT	SlimBox I/O Wall Mount Unit with 4 Internal SCA Adapters and 4 SM Pigtailes
301139713	WSE1S-004-SS41-GRY-SCUUNC-F	SlimBox I/O Wall Mount Unit with 4 Internal SCU Adapters
301139721	WSE1W-004-SS41-GRY-SCUUNC-F-PT	SlimBox I/O Wall Mount Unit with 4 Internal SCU Adapters and 4 SM Pigtailes

For additional information please contact your sales representative.

You can also visit our website at LIGHTERA.COM or call 1-888-FIBER-HELP (1-888-342-3743) from inside the USA or +1-770-798-5555 from outside the USA.

InvisiLight, EZ-Bend, and SlimBox are registered trademarks of Lightera, LLC. Lightera reserves the right to make changes to the prices and product(s) described in this document at any time without notice.

This document is for informational purposes only and is not intended to modify or supplement any Lightera warranties or specifications relating to any of its products or services.

Copyright © 2026 Lightera, LLC
All rights reserved, printed in USA.

Lightera Marketing
Communications

Date: 02/26

Revision: V1

For a full
list of our
certifications,
visit our
website